

## TUBI FLESSIBILI FLEXIBLE HYDRAULIC HOSES

		Descrizione - Description		Type	Page
	<b>NEW!</b>	TUBO FLESSIBILE FLEXIBLE HYDRAULIC HOSE	EN 853-1SN Exceed SAE 100 R1AT	1SN	394
	<b>NEW!</b>	TUBO FLESSIBILE FLEXIBLE HYDRAULIC HOSE	EN 853-2SN Exceed SAE 100 R2AT	2SN	394
	<b>NEW!</b>	TUBO FLESSIBILE FLEXIBLE HYDRAULIC HOSE	EN 857-1SC	1SC	395
	<b>NEW!</b>	TUBO FLESSIBILE FLEXIBLE HYDRAULIC HOSE	EN 857-2SC	2SC	395
	<b>NEW!</b>	TUBO FLESSIBILE FLEXIBLE HYDRAULIC HOSE	Exceed EN 857-1SC	1SC-LL	396
	<b>NEW!</b>	TUBO FLESSIBILE FLEXIBLE HYDRAULIC HOSE	Exceed EN 857-2SC	2SC-LL	396
	<b>NEW!</b>	TUBO FLESSIBILE FLEXIBLE HYDRAULIC HOSE	EN 856-4SP ISO 3862-4SP Exceed EN 856-4SH ISO 3862-4SH	4SP 4SH	397
	<b>NEW!</b>	TUBO FLESSIBILE FLEXIBLE HYDRAULIC HOSE	Exceed EN 857-1SC ISO 7751	1SC-JET	398
	<b>NEW!</b>	TUBO FLESSIBILE FLEXIBLE HYDRAULIC HOSE	Exceed EN 857-1SC ISO 7751	2SC-JET	398
	<b>NEW!</b>	TUBO FLESSIBILE FLEXIBLE HYDRAULIC HOSE	SAE 100 R7 SAE 100 R8	R7 R8	399
		TUBO FLESSIBILE FLEXIBLE HYDRAULIC HOSE	SAE 100 R6	R6	400
	<b>NEW!</b>	TUBO FLESSIBILE FLEXIBLE HYDRAULIC HOSE	SAE 100 R4	R4	400
		TUBO PVC PVC HOSE		PVC	401
	<b>NEW!</b>	SPIRALE E GUAINA TESSILE DI PROTEZIONE SPIRAL AND TEXTILE PROTECTION SHEATHS		GS GT	402

# TUBI FLESSIBILI - FLEXIBLE HYDRAULIC HOSES

## 1SN

### NEW!

## TUBO FLESSIBILE SAE 100 R1AT - EN 853-1SN FLEXIBLE HYDRAULIC HOSE SAE 100 R1AT - EN 853-1SN

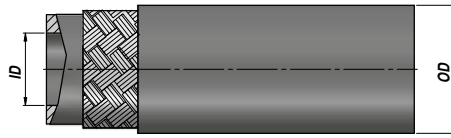
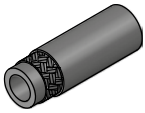

Codice Code	ID				OD mm	P MAX bar		BR min mm	Temperatura d'esercizio Working temperature	Colore Colour	Ghiera Ferrule	kg x 100 m
	size	inch	mm	DN		Esercizio Work	Scoppio Burst					
FGT103A000	03	3/16"	4.8	05	11.8	250	1000	90	-40°C - +100°C (120° intermittente - intermittent)	Nero Black	RPG001C.03	18,40
FGT104A000	04	1/4"	6.4	06	13.4	225	900	100			RPG001C.04	23,10
FGT105A000	05	5/16"	8.0	08	15.0	215	850	115			RPG001C.05	25,40
FGT106A000	06	3/8"	9.5	10	17.4	180	720	130			RPG001C.06	33,80
FGT108A000	08	1/2"	12.7	13	20.6	160	640	180			RPG001C.08	41,50
FGT110A000	10	5/8"	16.0	16	23.7	130	520	200			RPG001C.10	47,70
FGT112A000	12	3/4"	19.0	20	27.7	105	420	240			RPG001C.12	61,80
FGT116A000	16	1"	25.4	25	35.6	88	350	300			RPG001C.16	90,10
FGT120A000	20	1"1/4	31.8	32	43.5	63	250	420			RPG001C.20	127,00
FGT124A000	24	1"1/2	38.1	38	50.8	50	200	500			RPG001C.24	159,60
FGT132A000	32	2"	50.8	50	63.6	40	160	630			RPG001C.32	220,00

BR min = Raggio minimo di curvatura - Minimum bending radius

Sottostrato - Internal hose : Gomma sintetica resistente agli oli idraulici - Hydraulic oil resistant synthetic rubber

Rinforzo - Reinforcement : 1 Treccia in acciaio ad alta tenacità - 1 High tensile steel wire braid

Copertura - Cover : Gomma sintetica resistente agli oli, all'abrasione e agli agenti atmosferici - Oil, abrasion and weather resistant synthetic rubber

## 2SN

### NEW!

## TUBO FLESSIBILE SAE 100 R2AT - EN 853-2SN FLEXIBLE HYDRAULIC HOSE SAE 100 R2AT - EN 853-2SN

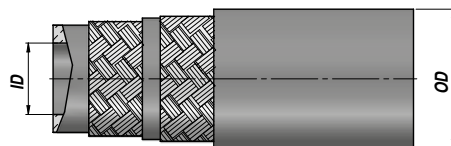
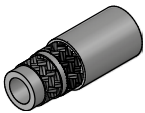

Codice Code	ID				OD mm	P MAX bar		BR min mm	Temperatura d'esercizio Working temperature	Colore Colour	Ghiera Ferrule	kg x 100 m
	size	inch	mm	DN		Esercizio Work	Scoppio Burst					
FGT203A000	03	3/16"	4.8	05	13.5	415	1650	90	-40°C - +100°C (120° intermittente - intermittent)	Nero Black	RPG0022.03	31,70
FGT204A000	04	1/4"	6.4	06	15.0	400	1600	100			RPG0022.04	36,00
FGT205A000	05	5/16"	8.0	08	16.6	350	1400	115			RPG0022.05	41,60
FGT206A000	06	3/8"	9.5	10	19.0	330	1320	130			RPG0022.06	52,50
FGT208A000	08	1/2"	12.7	13	22.2	275	1100	180			RPG0022.08	62,00
FGT210A000	10	5/8"	16.0	16	25.4	250	1000	200			RPG0022.10	75,20
FGT212A000	12	3/4"	19.0	20	29.3	215	850	240			RPG0022.12	92,30
FGT216A000	16	1"	25.4	25	38.1	165	650	300			RPG0022.16	137,70
FGT220A000	20	1"1/4	31.8	32	48.3	125	500	420			RPG0022.20	203,50
FGT224A000	24	1"1/2	38.1	38	54.6	90	360	500			RPG0022.24	230,00
FGT232A000	32	2"	50.8	50	66.9	80	320	630			RPG0022.32	316,00

BR min = Raggio minimo di curvatura - Minimum bending radius

Sottostrato - Internal hose : Gomma sintetica resistente agli oli idraulici - Hydraulic oil resistant synthetic rubber

Rinforzo - Reinforcement : 2 Treccie in acciaio ad alta tenacità - 2 High tensile steel wire braids

Copertura - Cover : Gomma sintetica resistente agli oli, all'abrasione e agli agenti atmosferici - Oil, abrasion and weather resistant synthetic rubber

**TUBO FLESSIBILE - EN 857-1SC**  
**FLEXIBLE HYDRAULIC HOSE - EN 857-1SC**

**NEW!**

**1SC**

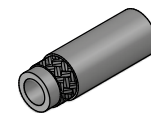
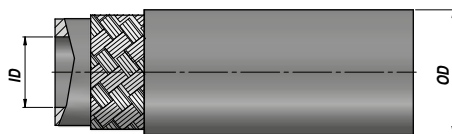

Codice Code	ID				OD mm	P MAX bar		BR min mm	Temperatura d'esercizio Working temperature (120° intermittente - intermittent)	Colore Colour	Ghiera Ferrule	kg x 100 m
	size	inch	mm	DN		Esercizio Work	Scoppio Burst					
FGFE001K04	04	1/4"	6.4	06	12.3	225	900	50	-40°C - +100°C (120° intermittente - intermittent)	Nero Black	RPG001C.04	18,20
FGFE001K05	05	5/16"	8.0	08	13.5	215	860	55			RPG001C.05	20,30
FGFE001K06	06	3/8"	9.5	10	15.7	180	720	60			RPG001C.06	24,80
FGFE001K08	08	1/2"	12.7	13	18.9	160	640	70			RPG001C.08	34,10
FGFE001K10	10	5/8"	16.0	16	22.4	130	520	90			RPG001C.10	42,10
FGFE001K12	12	3/4"	19.0	20	25.9	105	420	100			RPG001C.12	49,20
FGFE001K16	16	1"	25.4	25	33.7	88	352	180			RPG001C.16	74,20

BR min = Raggio minimo di curvatura - Minimum bending radius

Sottostrato - Internal hose : Gomma sintetica resistente agli oli idraulici - Hydraulic oil resistant synthetic rubber

Rinforzo - Reinforcement : 1 Treccia in acciaio ad alta tenacità - 1 High tensile steel wire braid

Copertura - Cover : Gomma sintetica resistente agli oli, all'abrasione e agli agenti atmosferici - Oil, abrasion and weather resistant synthetic rubber

**TUBO FLESSIBILE - EN 857-2SC**  
**FLEXIBLE HYDRAULIC HOSE - EN 857-2SC**

**NEW!**

**2SC**

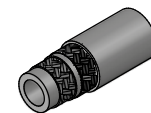
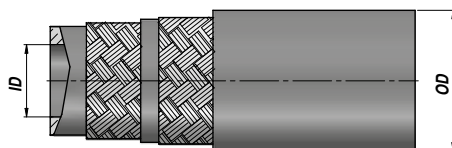

Codice Code	ID				OD mm	P MAX bar		BR min mm	Temperatura d'esercizio Working temperature (120° intermittente - intermittent)	Colore Colour	Ghiera Ferrule	kg x 100 m
	size	inch	mm	DN		Esercizio Work	Scoppio Burst					
FGFE002K04	04	1/4"	6.4	06	13.3	400	1600	50	-40°C - +100°C (120° intermittente - intermittent)	Nero Black	RPG001C.04	28,10
FGFE002K05	05	5/16"	8.0	08	14.8	350	1400	55			RPG001C.05	32,70
FGFE002K06	06	3/8"	9.5	10	17.1	330	1320	65			RPG001C.06	41,80
FGFE002K08	08	1/2"	12.7	13	20.4	275	1100	90			RPG001C.08	52,50
FGFE002K10	10	5/8"	16.0	16	23.5	250	1000	100			RPG001C.10	62,70
FGFE002K12	12	3/4"	19.0	20	27.6	215	860	120			RPG001C.12	78,20
FGFE002K16	16	1"	25.4	25	35.8	165	660	150			RPG001C.16	117,60

BR min = Raggio minimo di curvatura - Minimum bending radius

Sottostrato - Internal hose : Gomma sintetica resistente agli oli idraulici - Hydraulic oil resistant synthetic rubber

Rinforzo - Reinforcement : 2 Treccie in acciaio ad alta tenacità - 2 High tensile steel wire braids

Copertura - Cover : Gomma sintetica resistente agli oli, all'abrasione e agli agenti atmosferici - Oil, abrasion and weather resistant synthetic rubber

1SC-LL

NEW!

TUBO FLESSIBILE LONG LIFE - EN 857-1SC  
LONG LIFE FLEXIBLE HYDRAULIC HOSE - EN 857-1SC

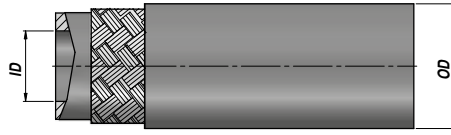
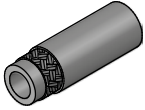

Codice Code	ID				OD mm	P MAX bar		BR min mm	Temperatura d'esercizio Working temperature (-40°C - +100°C (120° intermittente - intermittent))	Colore Colour Nero Black	Ghiera Ferrule	kg x 100 m
	size	inch	mm	DN		Esercizio Work	Scoppio Burst					
FGHE101K04	04	1/4"	6.4	06	12.3	250	1120	50			RPG001C.04	18,20
FGHE101K05	05	5/16"	8.0	08	13.5	250	1000	55			RPG001C.05	21,00
FGHE101K06	06	3/8"	9.5	10	15.7	250	1000	60			RPG001C.06	24,80
FGHE101K08	08	1/2"	12.7	13	18.9	200	800	70			RPG001C.08	39,10
FGHE101K10	10	5/8"	16.0	16	22.4	150	600	90			RPG001C.10	41,00
FGHE101K12	12	3/4"	19.0	20	26.0	150	600	100			RPG001C.12	53,40

BR min = Raggio minimo di curvatura - Minimum bending radius

Sottostrato - Internal hose : Gomma sintetica resistente agli oli idraulici - Hydraulic oil resistant synthetic rubber

Rinforzo - Reinforcement : 1 Treccia in acciaio ad alta tenacità - 1 High tensile steel wire braid

Copertura - Cover : Gomma liscia sintetica resistente agli oli, all'abrasione e agli agenti atmosferici - Oil, abrasion and weather resistant smooth synthetic rubber

2SC-LL

NEW!

TUBO FLESSIBILE LONG LIFE - EN 857-2SC  
LONG LIFE FLEXIBLE HYDRAULIC HOSE - EN 857-2SC

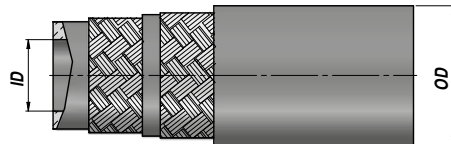
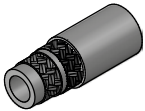

Codice Code	ID				OD mm	P MAX bar		BR min mm	Temperatura d'esercizio Working temperature (-40°C - +100°C (120° intermittente - intermittent))	Colore Colour Nero Black	Ghiera Ferrule	kg x 100 m
	size	inch	mm	DN		Esercizio Work	Scoppio Burst					
FGHE102K04	04	1/4"	6.4	06	13.3	430	1720	50			RPG001C.04	28,30
FGHE102K05	05	5/16"	8.0	08	14.8	400	1600	60			RPG001C.05	32,40
FGHE102K06	06	3/8"	9.5	10	17.1	350	1400	70			RPG001C.06	41,80
FGHE102K08	08	1/2"	12.7	13	20.4	310	1240	80			RPG001C.08	52,10
FGHE102K10	10	5/8"	16.0	16	23.5	280	1120	100			RPG001C.10	62,60
FGHE102K12	12	3/4"	19.0	20	27.6	240	960	120			RPG001C.12	76,40
FGHE102K16	16	1"	25.4	25	35.8	185	740	160	RPG001C.16	117,10		

BR min = Raggio minimo di curvatura - Minimum bending radius

Sottostrato - Internal hose : Gomma sintetica resistente agli oli idraulici - Hydraulic oil resistant synthetic rubber

Rinforzo - Reinforcement : 2 Treccie in acciaio ad alta tenacità - 2 High tensile steel wire braids

Copertura - Cover : Gomma liscia sintetica resistente agli oli, all'abrasione e agli agenti atmosferici - Oil, abrasion and weather resistant smooth synthetic rubber

**TUBO FLESSIBILE EN 856-4SP - ISO 3862-4SP**  
**FLEXIBLE HYDRAULIC HOSE EN 856-4SP - ISO 3862-4SP**

**NEW!**

**4SP**

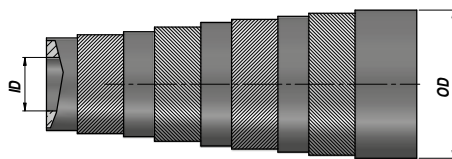

Codice Code	ID				OD mm	P MAX bar		BR min mm	Temperatura d'esercizio Working temperature	Colore Colour	Ghiera Ferrule	kg x 100 m
	size	inch	mm	DN		Esercizio Work	Scoppio Burst					
FG404A0000	04	1/4"	6.4	06	17.8	450	1800	150	-40°C - +100°C ( 120° intermittente - intermittent )	Nero Black	RPG9040000	59,20
FG406A0000	06	3/8"	9.5	10	21.4	445	1780	180			RPG9060000	79,00
FG408A0000	08	1/2"	12.7	13	24.6	415	1660	230			RPG9080000	94,00
FG410A0000	10	5/8"	16.0	16	28.5	350	1400	250			RPG9100000	112,50
FG412A0000	12	3/4"	19.0	20	32.1	350	1400	300			RPG9120000	149,70
FG416A0000	16	1"	25.4	25	39.7	280	1120	340			RPG9160000	215,00
FG420A0000	20	1"1/4	31.8	32	50.8	210	840	460			RPG9200000	315,70
FG424A0000	24	1"1/2	38.1	38	57.1	185	740	560			RPG9240000	371,30
FG432A0000	32	2"	50.8	50	70.6	165	660	660			RPG9320000	487,00

BR min = Raggio minimo di curvatura - Minimum bending radius

Sottostrato - Internal hose : Gomma sintetica resistente agli oli idraulici - Hydraulic oil resistant synthetic rubber

Rinforzo - Reinforcement : 4 Spirali in acciaio ad altissima resistenza - 4 High tensile steel spirals

Copertura - Cover : Gomma sintetica resistente agli oli, all'abrasione e agli agenti atmosferici - Oil, abrasion and weather resistant synthetic rubber

**TUBO FLESSIBILE EN 856-4SH - ISO 3862-4SH**  
**FLEXIBLE HYDRAULIC HOSE EN 856-4SH - ISO 3862-4SH**

**NEW!**

**4SH**

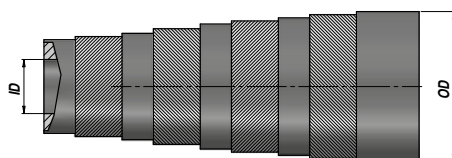

Codice Code	ID				OD mm	P MAX bar		BR min mm	Temperatura d'esercizio Working temperature	Colore Colour	Ghiera Ferrule	kg x 100 m
	size	inch	mm	DN		Esercizio Work	Scoppio Burst					
FG512A0000	12	3/4"	19.0	20	32.0	420	1780	210	-40°C - +100°C ( 120° intermittente - intermittent )	Nero Black	RPG5120000	157,20
FG516A0000	16	1"	25.4	25	38.4	385	1750	220			RPG5160000	210,40
FG520A0000	20	1"1/4	31.8	32	45.8	350	1400	400			RPG004H.20	255,00
FG524A0000	24	1"1/2	38.1	38	53.5	300	1250	560			RPG004H.24	322,50

BR min = Raggio minimo di curvatura - Minimum bending radius

Sottostrato - Internal hose : Gomma sintetica resistente agli oli idraulici - Hydraulic oil resistant synthetic rubber

Rinforzo - Reinforcement : 4 Spirali in acciaio ad altissima resistenza - 4 High tensile steel spirals

Copertura - Cover : Gomma sintetica resistente agli oli, all'abrasione e agli agenti atmosferici - Oil, abrasion and weather resistant synthetic rubber

1SC-JET

NEW!

TUBO FLESSIBILE - EXCEED EN 857-1SC ISO 7751  
FLEXIBLE HYDRAULIC HOSE - EXCEED EN 857-1SC ISO 7751

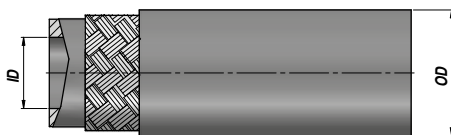
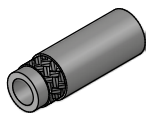

Codice Code	ID				OD mm	P MAX bar		BR min mm	Temperatura d'esercizio Working temperature (155° intermittente - intermittent)	Colore Colour	Ghiera Ferrule	kg x 100 m
	size	inch	mm	DN		Esercizio Work	Scoppio Burst					
FGFB001K04	04	1/4"	6.4	06	12.4	250	1000	75		Blu Blue	RPG001C.04	18,20
FGFB001K05	05	5/16"	8.0	08	14.0	250	1000	85			RPG001C.05	20,30
FGFB001K06	06	3/8"	9.5	10	15.6	250	1000	90			RPG001C.06	25,60
FGFB001K08	08	1/2"	12.7	13	18.7	250	1000	130			RPG001C.08	34,10

BR min = Raggio minimo di curvatura - Minimum bending radius

Sottostrato - Internal hose : Gomma sintetica resistente all'acqua, emulsioni acqua-sapone e acqua-glicole - Water, water-soap based, glycol-water based resistant synthetic rubber

Rinforzo - Reinforcement : 1 Treccia in acciaio ad alta tenacità - 1 High tensile steel wire braid

Copertura - Cover : Gomma liscia sintetica resistente agli oli, all'abrasione e agli agenti atmosferici - Oil, abrasion and weather resistant smooth synthetic rubber

2SC-JET

NEW!

TUBO FLESSIBILE - EXCEED EN 857-2SC ISO 7751  
FLEXIBLE HYDRAULIC HOSE - EXCEED EN 857-2SC ISO 7751

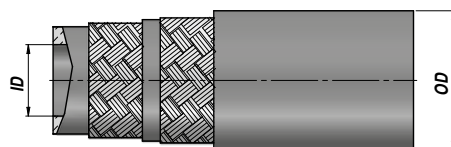
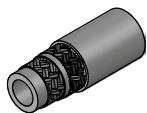

Codice Code	ID				OD mm	P MAX bar		BR min mm	Temperatura d'esercizio Working temperature (155° intermittente - intermittent)	Colore Colour	Ghiera Ferrule	kg x 100 m
	size	inch	mm	DN		Esercizio Work	Scoppio Burst					
FGFB002K04	04	1/4"	6.4	06	13.4	400	1600	85		Blu Blue	RPG001C.04	28,10
FGFB002K05	05	5/16"	8.0	08	15.0	400	1600	85			RPG001C.05	32,70
FGFB002K06	06	3/8"	9.5	10	17.4	400	1600	90			RPG001C.06	41,80
FGFB002K08	08	1/2"	12.7	13	20.6	400	1600	130			RPG001C.08	57,40

BR min = Raggio minimo di curvatura - Minimum bending radius

Sottostrato - Internal hose : Gomma sintetica resistente all'acqua, emulsioni acqua-sapone e acqua-glicole - Water, water-soap based, glycol-water based resistant synthetic rubber

Rinforzo - Reinforcement : 2 Treccia in acciaio ad alta tenacità - 2 High tensile steel wire braid

Copertura - Cover : Gomma liscia sintetica resistente agli oli, all'abrasione e agli agenti atmosferici - Oil, abrasion and weather resistant smooth synthetic rubber

**TUBO FLESSIBILE SAE 100 R7 - TERMOPLASTICO**  
**FLEXIBLE HYDRAULIC HOSE SAE 100 R7 - THERMOPLASTIC**

**NEW!**

**R7**

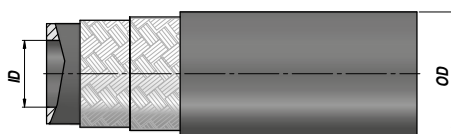

Codice Code	ID				OD mm	P MAX bar		BR min mm	Temperatura d'esercizio Working temperature -40°C - +100°C	Colore Colour Nero Black	Ghiera Ferrule	kg x 100 m
	size	inch	mm	DN		Esercizio Work	Scoppio Burst					
FG703A0000	03	3/16"	4.8	05	10.0	210	840	30	-40°C - +100°C	Nero Black	RPG0007.03	7,30
FG704A0000	04	1/4"	6.4	06	11.8	200	800	35			RPG0007.04	9,00
FG705A0000	05	5/16"	8.0	08	14.3	190	760	45			RPG0007.05	12,80
FG706A0000	06	3/8"	9.7	10	16.0	175	700	55			RPG0007.06	15,50
FG708A0000	08	1/2"	13.0	13	20.3	140	560	75			RPG0007.08	21,90
FG712A0000	12	3/4"	19.2	20	26.5	90	360	145			RPG0007.12	33,00

BR min = Raggio minimo di curvatura - Minimum bending radius

Sottostrato - Internal hose: Poliestere resistente agli oli idraulici, aria e fluidi a base acquosa - Hydraulic oil, air and water based fluids resistant polyester

Rinforzo - Reinforcement : 2 Trecce in fibre di poliestere ad alta tenacità - 2 High tensile polyester fibre braids

Copertura - Cover : Poliuretano antiabrasione, resistente all'olio e agli agenti atmosferici - Oil, abrasion and weather resistant polyurethane

**TUBO FLESSIBILE SAE 100 R8 - TERMOPLASTICO**  
**FLEXIBLE HYDRAULIC HOSE SAE 100 R8 - THERMOPLASTIC**

**NEW!**

**R8**

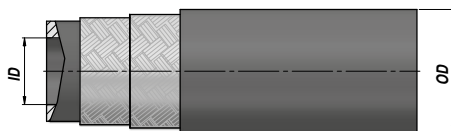

Codice Code	ID				OD mm	P MAX bar		BR min mm	Temperatura d'esercizio Working temperature -40°C - +100°C	Colore Colour Nero Black	Ghiera Ferrule	kg x 100 m
	size	inch	mm	DN		Esercizio Work	Scoppio Burst					
FG803A0000	03	3/16"	4.8	05	10.0	350	1400	35	-40°C - +100°C	Nero Black	RPG0008.03	7,20
FG804A0000	04	1/4"	6.4	06	11.8	350	1400	50			RPG0008.04	8,50
FG805A0000	05	5/16"	8.0	08	14.3	325	1300	60			RPG0008.05	12,60
FG806A0000	06	3/8"	9.7	10	16.0	280	1120	70			RPG0008.06	14,60
FG808A0000	08	1/2"	13.0	13	20.3	245	980	95			RPG0008.08	22,50
FG812A0000	12	3/4"	19.2	20	26.5	165	660	150			RPG0008.12	35,20

BR min = Raggio minimo di curvatura - Minimum bending radius

Sottostrato - Internal hose: Poliestere resistente agli oli idraulici, aria e fluidi a base acquosa - Hydraulic oil, air and water based fluids resistant polyester

Rinforzo - Reinforcement : 2 Trecce in fibra tessile ad alta tenacità - 2 High syntetic textile braids

Copertura - Cover : Poliuretano antiabrasione, resistente all'olio e agli agenti atmosferici - Oil, abrasion and weather resistant polyurethane

# TUBI FLESSIBILI - FLEXIBLE HYDRAULIC HOSES

## R6

**NEW!**

### TUBO FLESSIBILE SAE 100 R6 FLEXIBLE HYDRAULIC HOSE SAE 100 R6

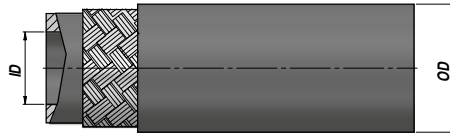
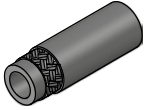

Codice Code	ID				OD mm	P MAX bar		BR min mm	Temperatura d'esercizio Working temperature	Colore Colour	Ghiera Ferrule	kg x 100 m
	size	inch	mm	DN		Esercizio Work	Scoppio Burst					
FG604A0000	04	1/4"	6.4	06	12.3	28	100	65	-40°C - +100°C	Nero Black	RPG0007.04	10,00
FG605A0000	05	5/16"	8.0	08	13.9	28	100	80			RPG0007.05	12,50
FG606A0000	06	3/8"	9.5	10	15.5	28	100	80			RPG0007.06	15,00
FG608A0000	08	1/2"	12.7	13	19.0	28	100	100			RPG0007.08	20,00
FG610A0000	10	5/8"	16.0	16	22.6	24	90	125			RPG0007.10	25,00
FG612A0000	12	3/4"	19.0	20	25.8	21	80	150			RPG0007.12	30,00
FG616A0000	16	1"	25.4	25	33.2	9	30	170			RPG0007.16	45,00

BR min = Raggio minimo di curvatura - Minimum bending radius

Sottostrato - Internal hose : Gomma sintetica resistente agli oli idraulici - Hydraulic oil resistant synthetic rubber

Rinforzo - Reinforcement : 1 Treccia tessile - 1 Synthetic textile braid

Copertura - Cover : Gomma sintetica resistente agli oli, all'abrasione e agli agenti atmosferici - Oil, abrasion and weather resistant synthetic rubber

## R4

### TUBO FLESSIBILE SAE 100 R4 FLEXIBLE HYDRAULIC HOSE SAE 100 R4

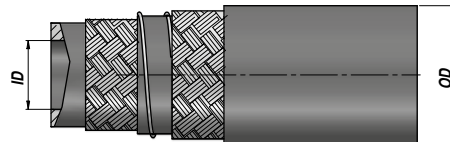
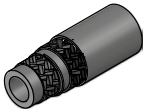

Codice Code	ID				OD mm	P MAX bar		BR min mm	Temperatura d'esercizio Working temperature	Colore Colour	Ghiera Ferrule	kg x 100 m
	size	inch	mm	DN		Esercizio Work	Scoppio Burst					
FGA1600000 <b>NEW!</b>	10	5/8"	16.0	16	27.0	21	63	112	-40°C - +100°C	Nero Black	-	57,00
FGA1900000	12	3/4"	19.0	20	29.5	21	63	120			-	59,00
FGA2500000	16	1"	25.0	25	35.5	17	51	145			-	74,00
FGA3200000	20	1"1/4"	32.0	32	42.5	14	42	195			-	90,00
FGA3800000	24	1"1/2"	38.0	38	49.0	10	30	228			-	111,00
FGA5000000	32	2"	51.0	50	62.0	7	21	300			-	143,00

BR min = Raggio minimo di curvatura - Minimum bending radius

Sottostrato - Internal hose : Gomma sintetica resistente agli oli idraulici - Hydraulic oil resistant synthetic rubber

Rinforzo - Reinforcement : 2 Treccie tessili + spirale metallica - 2 Synthetic textile braids + steel wire spiral

Copertura - Cover : Gomma sintetica resistente agli oli, all'abrasione e agli agenti atmosferici - Oil, abrasion and weather resistant synthetic rubber



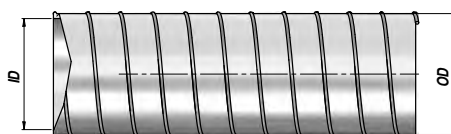

Codice Code	ID				OD mm	P MAX bar		BR min mm	Temperatura d'esercizio Working temperature	Colore Colour	Ghiera Ferrule	kg x 100 m
	size	inch	mm	DN		Esercizio Work	Scoppio Burst					
FGAV160000	10	5/8"	16	16	22.0	6	-	64	-5°C - +60°C	Trasparente Transparent	-	25,00
FGAV190000	12	3/4"	20	20	28.0	5	-	80			-	34,00
FGAV250000	16	1"	25	25	33.0	5	-	100			-	53,00
FGAV320000	20	1"1/4	32	32	40.0	4	-	128			-	65,50
FGAV380000	24	1"1/2	38	38	48.0	4	-	152			-	85,50
FGAV500000	32	2"	51	50	61.0	3	-	204			-	123,00

BR min = Raggio minimo di curvatura - Minimum bending radius

Sottostrato - Internal hose: PVC, liscio, leggero, molto flessibile, atossico - Smooth, light and very flexible, non toxic PVC

Rinforzo - Reinforcement : Spirale in acciaio zincato - Galvanized steel wire spiral

Copertura - Cover : Liscio, resistente ai carichi, all'abrasione e agli agenti atmosferici - Smooth, crushing, abrasion and weather resistant



#### CRIMPING CENTER

A crimping centre is present at our premises able to meet any supply demands. The hoses and fittings used for assembling are produced by leading companies in the sector.

#### CENTRO RACCORDATURA

Disponiamo di un centro raccordatura per tubi flessibili in grado di soddisfare ogni richiesta di fornitura. I tubi e i raccordi utilizzati per l'assemblaggio sono prodotti da aziende leader del settore.



GS

NEW!

SPIRALE DI PROTEZIONE  
PROTECTION SPIRAL

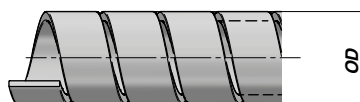
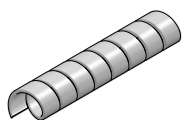

Codice Code	Tipo Type	OD mm	Spessore Thickness mm	Larghezza banda Strip Width	Valido per Valid for	Temperatura d'esercizio Working temperature	Colore Colour	kg x 100 m
FGSPIR0900	GS128	12	1.5	10.0	∅ 10 ÷ 17	-20°C - +100°C	Nero Black	4,60
FGSPIR1300	GS1612	16	1.5	12.0	∅ 12 ÷ 22			6,00
FGSPIR1600	GS2016	20	1.8	14.5	∅ 16 ÷ 27			7,30
FGSPIR2000	GS2520	25	2.0	21.0	∅ 22 ÷ 35			11,20
FGSPIR2800	GS3227	32	2.0	24.0	∅ 27 ÷ 43			14,30
FGSPIR3600	GS4036	40	2.5	30.0	∅ 33 ÷ 55			21,70
FGSPIR4500	GS5044	50	3.0	35.0	∅ 42 ÷ 64			27,80
FGSPIR5000	GS6356	63	3.5	40.0	∅ 52 ÷ 75			58,80
FGSPIR6000	GS7567	75	3.4	40.0	∅ 65 ÷ 96			81,30
FGSPIR6500	GS9080	90	5.0	45.0	∅ 80 ÷ 125			103,30
FGSPIR9900	GS110100	110	5.5	55.0	∅ 97 ÷ 150			120,00

Buona resistenza all'abrasione e ai raggi U.V. - Good resistance to abrasion and U.V. rays.

MATERIALE : POLIETILENE  
MATERIAL : POLYETHYLENE

GT

NEW!

GUAINATESSILE DI PROTEZIONE  
TEXTILE PROTECTION SHEATHS

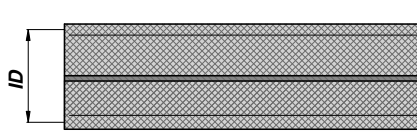
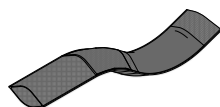

Codice Code	Tipo Type	Larghezza Width	ID mm	Temperatura d'esercizio Working temperature	Colore Colour	kg x 100 m
FGGT035020	GT35	35	20	-40°C - +100°C	Nero Black	2,70
FGGT040022	GT40	40	22			3,20
FGGT045025	GT45	45	25			3,40
FGGT050028	GT50	50	28			3,80
FGGT055032	GT55	55	32			4,20
FGGT060035	GT60	60	35			4,50
FGGT065038	GT65	65	38			4,80
FGGT080045	GT80	80	45			6,00
FGGT090050	GT90	90	50			6,50
FGGT120070	GT120	120	70			9,60
FGGT150090	GT150	150	90			11,20

Buona resistenza all'abrasione, ai raggi U.V. e alle sollecitazioni meccaniche. - Good resistance to abrasion, U.V. rays and mechanical stress.

Compatibile con oli e prodotti organici. - Compatibility with oils and organic products.